

**CEILING & WALL MATERIAL LIST**

1. STEEL REBAR  
 48 PIECES 7 FT LONG  
 32 PIECES 11'-6" LONG  
 44 PIECES 48" BENT AT 90° IN MIDDLE FOR CORNERS

NOTE:  
 REBAR COMES IN 20 FOOT LENGTHS AND MUST BE CUT. REBAR CAN BE CUT WITH A SKILL SAW WITH CARBIDE BLADE.

ALL REBAR SHOULD BE  $\frac{3}{8}$ " TO  $\frac{1}{2}$ " OR NO.3 OR NO.4 ROD. SPACED 12" APART RUNNING BOTH DIRECTIONS.

NOTE:  
 USE BRICK PIECES TO RAISE REBAR OFF GROUND

BACK EACH FORM PANEL WITH  $\frac{1}{2}$ " PLYWOOD

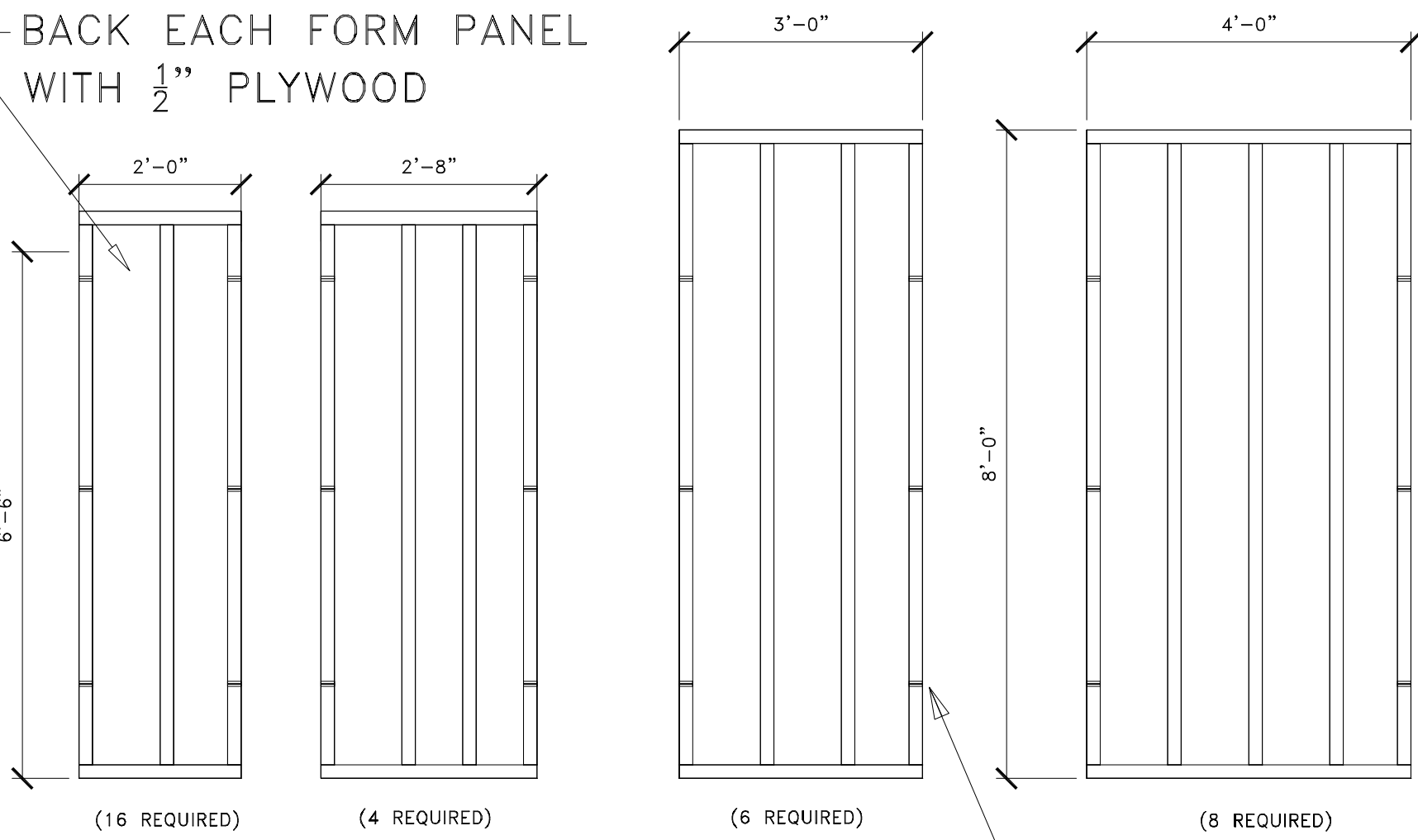

**CONCRETE FORM PANELS**

SCALE: 1/2" = 1'-0"

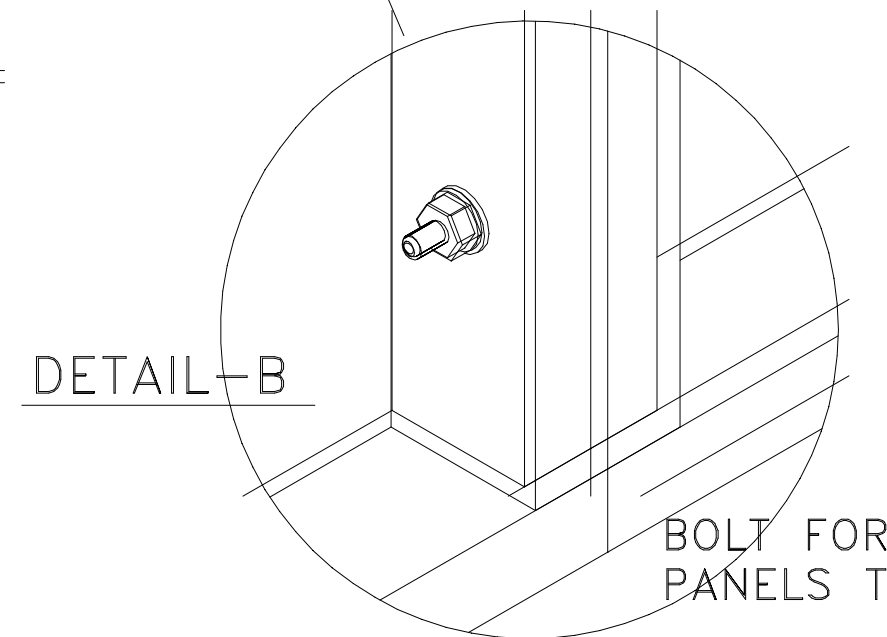

2"X6"X12 FOOT FORM BOARD TWO SIDES

2"X6"X14 FOOT FORM BOARD TWO SIDE

CONCRETE PAD LAYOUT & RE-BAR ARRANGEMENT

WOOD STAKES TYP

- STEEL MATERIAL LIST**  
 22 PIECES OF ROD 11'-6" LONG  
 44 PIECES OF ROD BENT 90° ANGLE 48" LONG  
 TIE WIRE

90° BENT REBAR TIED TO ENDS OF REBAR IN FLOOR. ENDS SHOULD EXTEND 12" MIN OUT OF FLOOR SLAB

IMPORTANT BLOCK OUT DOOR OPENING, VENTS, GLASS BLOCK, ETC., WITHIN THE FORM

TYP FORM TIE RODS

$\frac{1}{2}$ " PLYWOOD OVER 2X6 CEILING JOIST

CONCRETE SLAB: 72 CU.FT, 2.66 CU.YDS.  
 WALLS & CEILING 264 CU.FT. OR 10 CU.YDS.  
 TOTAL: 12.66 CU.YDS.

USE 4"Ø PVC PIPE FOR VENT

6" THICK SOLID REINFORCED CONCRETE, ROOF, WALLS AND FLOOR STORM SHELTER

REBAR TYP

**CONCRETE FORM CUT-AWAY**

RIM JOIST & CEILING JOIST REST ON TOP OF FORM PANELS

WET CONCRETE IS EXSTREAMLY HEAVY AND THE FORMS MUST BE SECURLY BRACED

TEMPORARY INSIDE SUPPORT WALL

**3D VIEW**

REMEMBER  
 1. A STORM SHELTER DOES NOT HAVE TO BE BELOW GROUND  
 2. IT SHOULD BE EASY & QUICK TO GET TO.

REBAR SHOULD BE TIED WITH WIRE

CLEARANCE FOR DOOR

GLASS BLOCK

4"Ø VENT

CEILING LIGHTING

**FLOOR PLAN**

SCALE: 1/2" = 1'-0"

110V OUTLET TYPICAL

**DETAIL-A**

CUT-AWAY

PHONE JACK SWITCH

36"X80" HIGH STEEL SECURED DOOR

VENT

GLASS BLOCK

GLASS BLOCK

PROJECT TITLE  
**SAFE STORM SHELTER**  
 JKC + S.H., 544 NASHVILLE PIKE, SUITE #339, GALLATIN, TN 37066

SHEET  
**A**

JOB NO:  
**08615-1A**  
 3-31-08